

Remove Grill Nut



Place Rear Grill onto Fan Motor and Line Up with the 3 Positioning Knobs



Replace the Grill Nut and Tighten



Place the Fan Blade over the motor shaft and make sure to line the up the notch with the notch on the blade push it back firmly

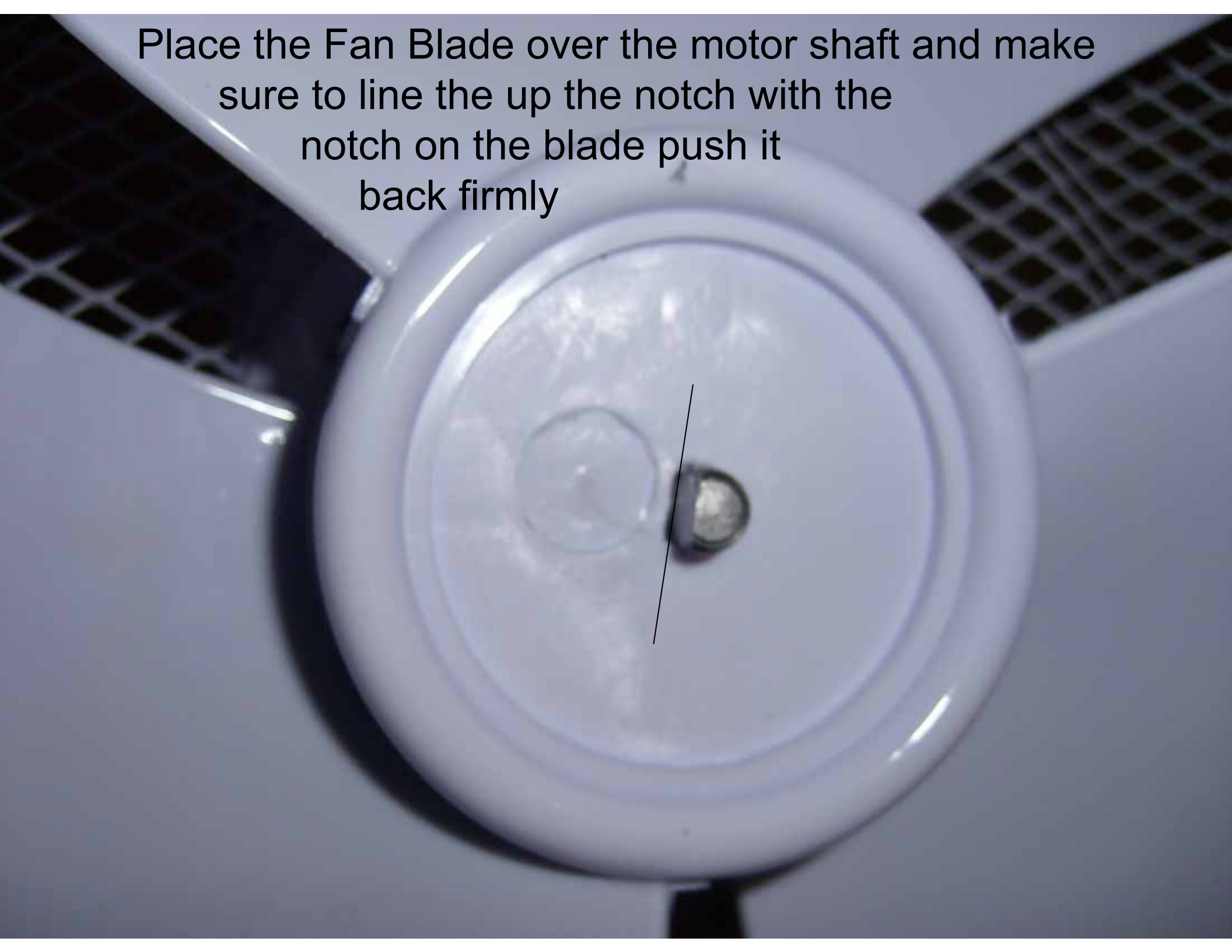

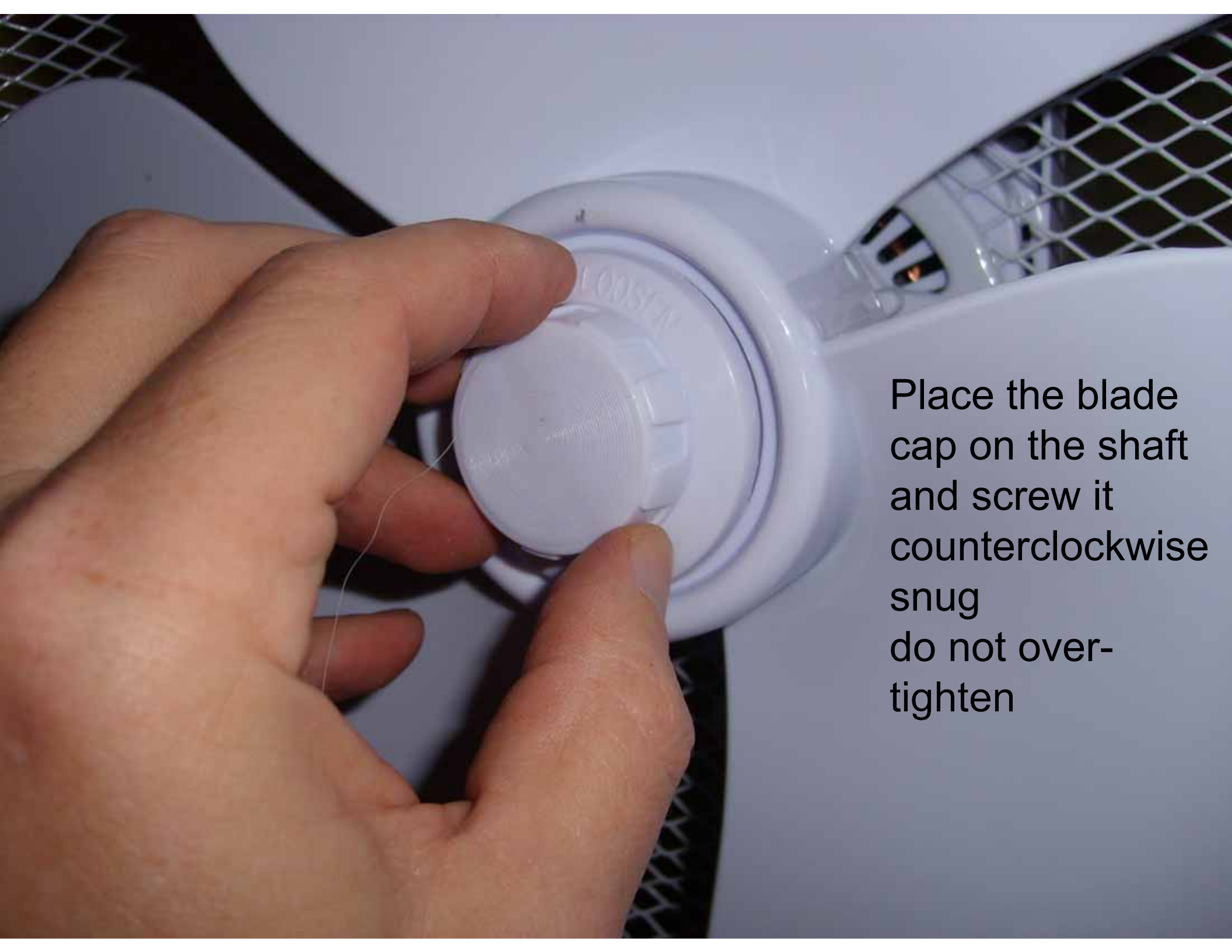

Place the blade cap on the shaft and screw it counterclockwise snug do not over-tighten

open all the grill
fastening clips



Hang the front safety grill on back grill as shown

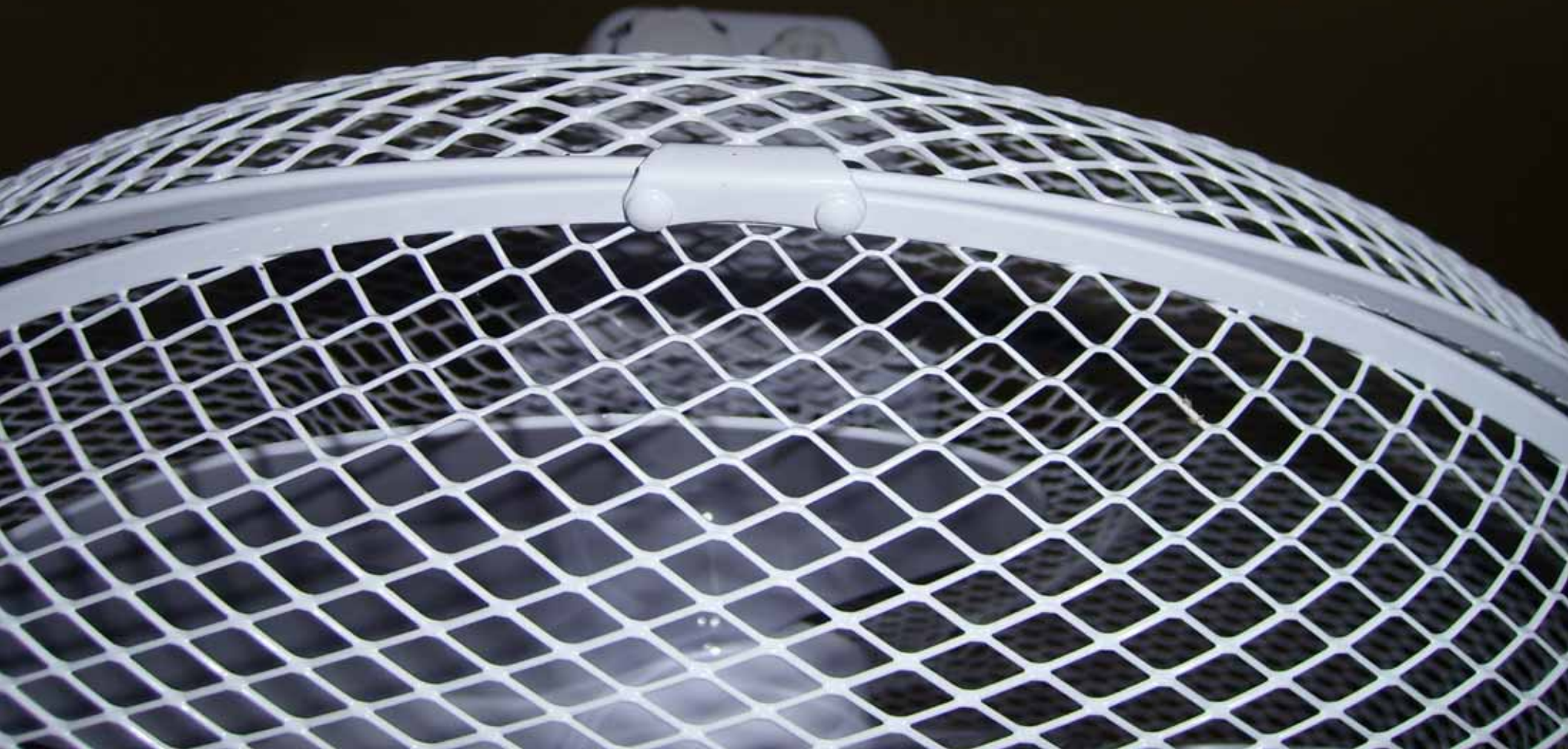

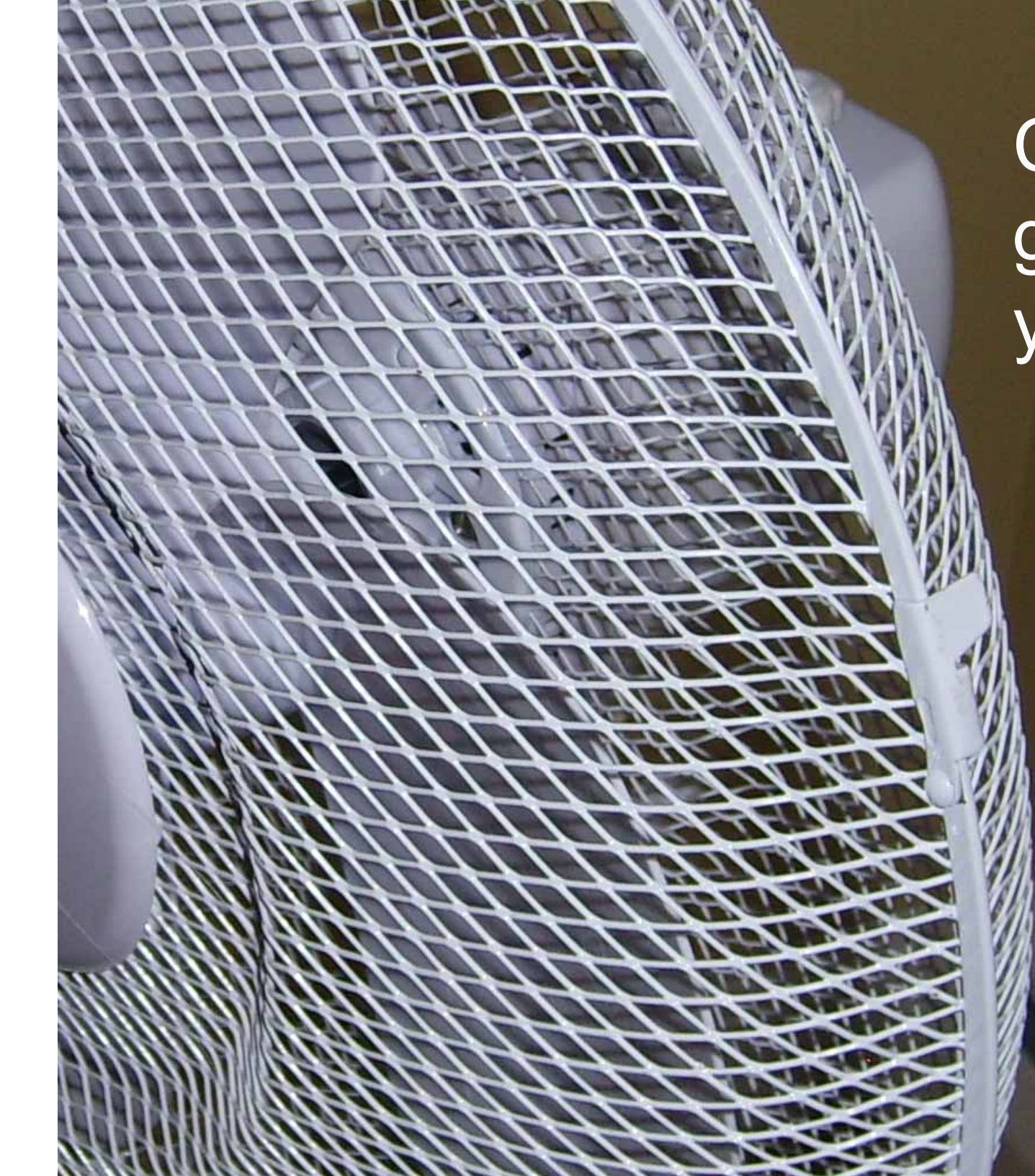

Close all the
grill clips
your done